

D

1704

PORT RICHEY WAY

D



FRONT ELEVATION

53'-4"

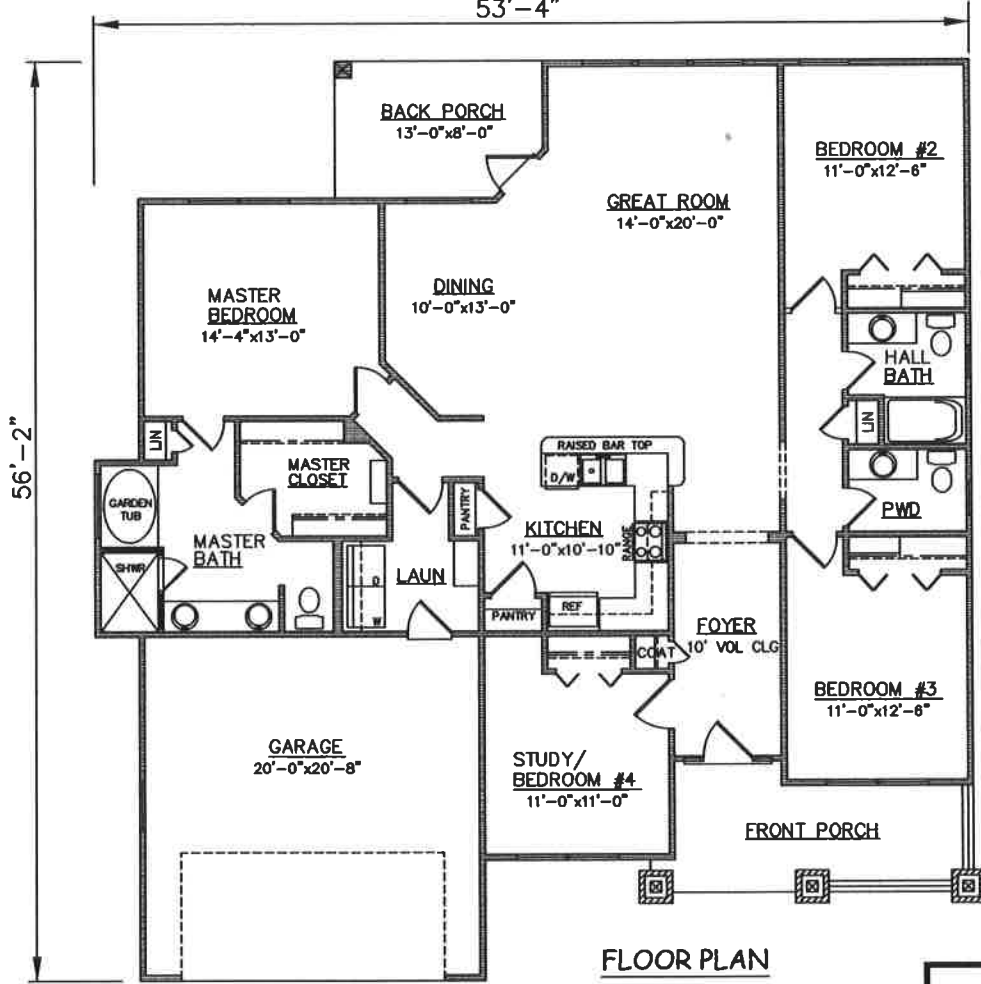

FLOOR PLAN

PLAN NO.
CW1928/2596

SQUARE FOOTAGE	
Heated Sq. Ft.:	1928
Garage:	436
Front Porch:	131
Back Porch:	101
Total Under Roof:	2596

3805 COMMUNITY ROAD
BRUNSWICK, GEORGIA
(912)265-3021
www.driggershomes.com



SERVING GLYNN COUNTY
SINCE 1962

THE INFORMATION, PLANS, SPECIFICATIONS, AND DESIGNS APPEARING IN THESE DRAWINGS ARE THE PROPERTY OF DRIGGERS HOMES, INC.; ANY UNAUTHORIZED USE OR DUPLICATION IN WHOLE OR IN PART IS STRICTLY PROHIBITED.

NEW HOME COLLECTION

THESE ARE RENDERINGS ONLY. ACTUAL FLOOR PLANS & ELEVATIONS MAY VARY FROM DRAWINGS.