

D

1706

37 MILLPOND CIRCLE

D



FRONT ELEVATION

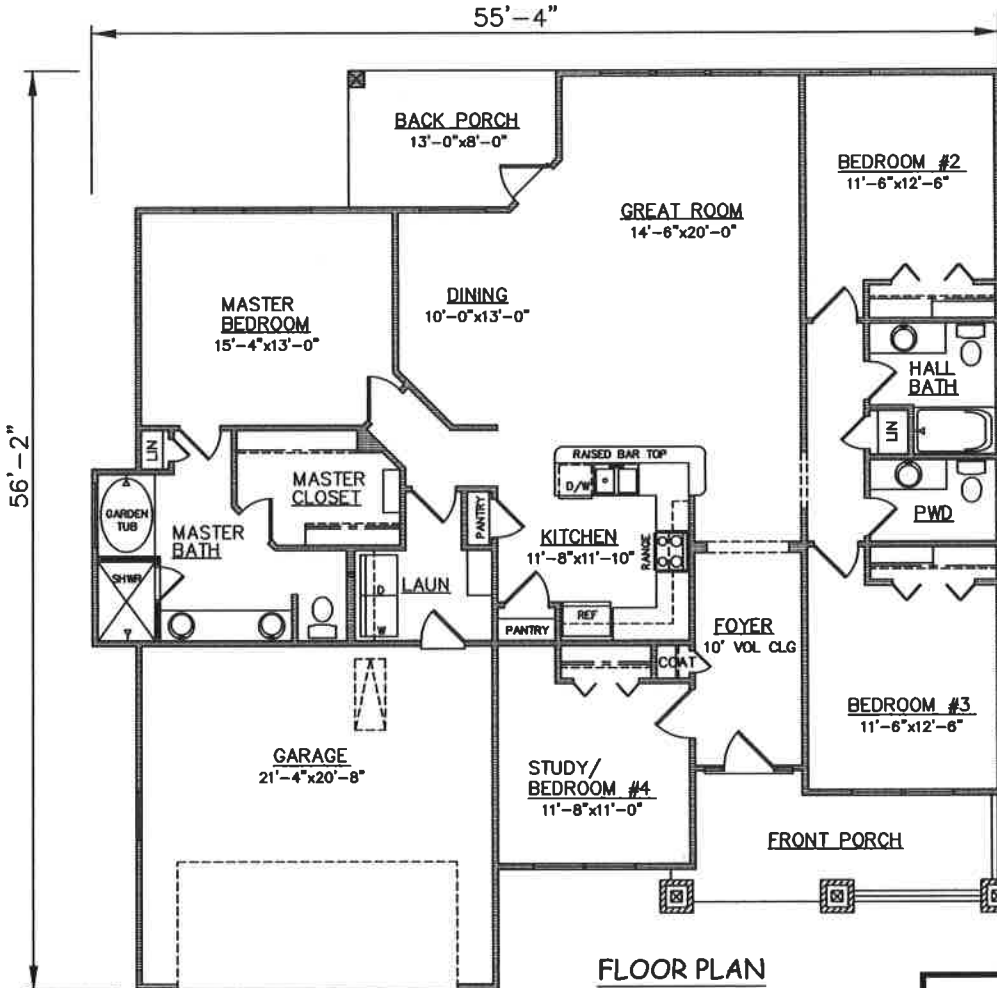

FLOOR PLAN

PLAN NO.  
CW2001/2693

SQUARE FOOTAGE	
Heated Sq. Ft.:	2001
Garage:	457
Front Porch:	134
Back Porch:	101
Total Under Roof:	2693

3805 COMMUNITY ROAD  
BRUNSWICK, GEORGIA  
(912)265-3021  
www.driggershomes.com



SERVING GLYNN COUNTY  
SINCE 1962

THE INFORMATION, PLANS, SPECIFICATIONS, AND DESIGNS APPEARING IN THESE DRAWINGS ARE THE PROPERTY OF DRIGGERS HOMES, INC.; ANY UNAUTHORIZED USE OR DUPLICATION IN WHOLE OR IN PART IS STRICTLY PROHIBITED.

NEW HOME COLLECTION

THESE ARE RENDERINGS ONLY. ACTUAL FLOOR PLANS & ELEVATIONS MAY VARY FROM DRAWINGS.