

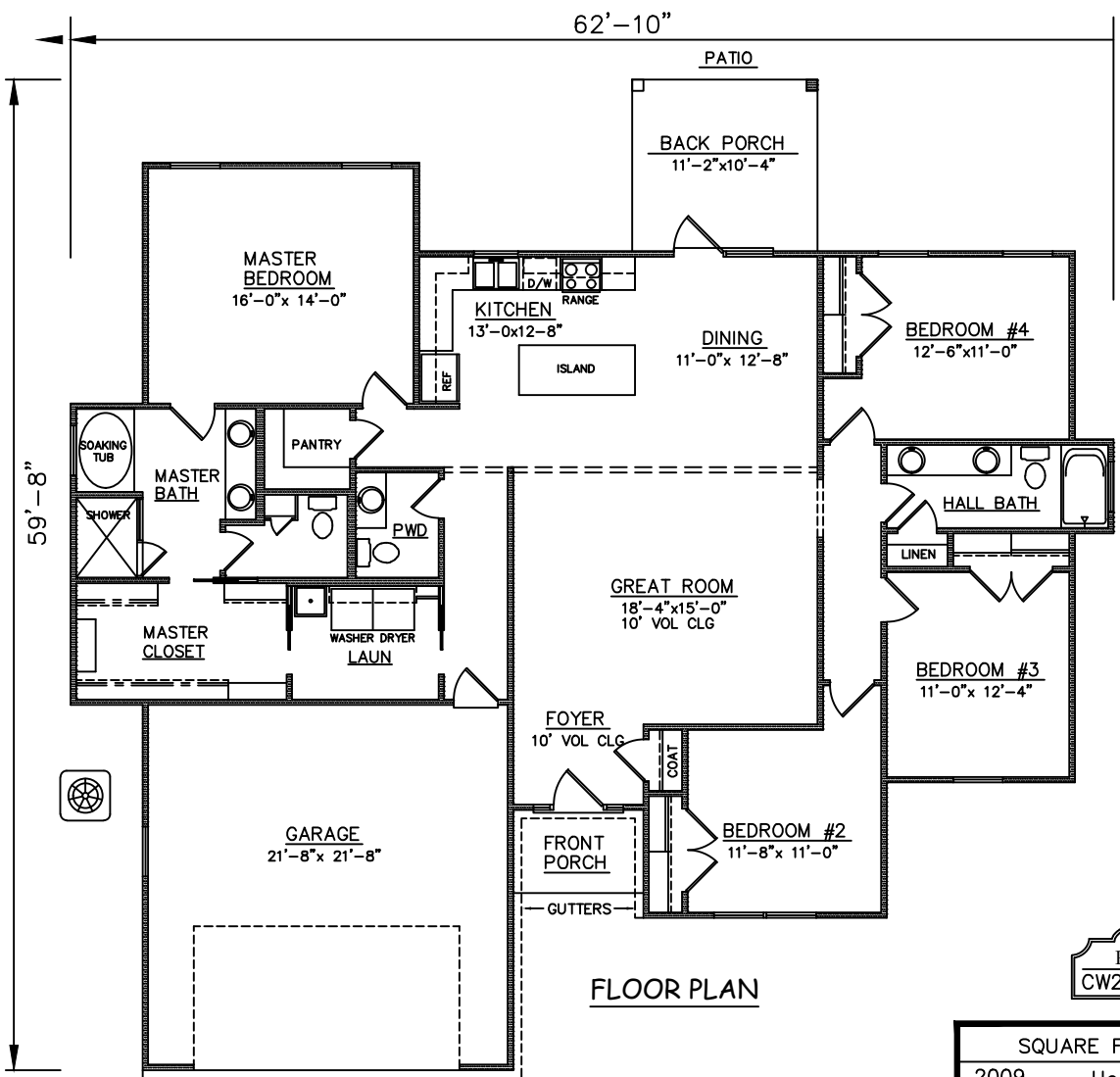

STUCCO EXTERIOR

FRONT ELEVATION

STONE ON FRONT AS SHOWN



FLOOR PLAN

PLAN NO.
CW2009/2652

SQUARE FOOTAGE	
2009	Heated Sq. Ft.:
489	Garage:
39	Front Porch:
115	Back Porch:
2652	Total Under Roof:

3805 COMMUNITY ROAD
BRUNSWICK, GEORGIA
(912)265-3021
www.driggershomes.com



SERVING GLYNN COUNTY
SINCE 1962

THE INFORMATION, PLANS, SPECIFICATIONS, AND DESIGNS APPEARING IN THESE DRAWINGS ARE THE PROPERTY OF DRIGGERS HOMES, INC.; ANY UNAUTHORIZED USE OR DUPLICATION IN WHOLE OR IN PART IS STRICTLY PROHIBITED.

NEW HOME COLLECTION

THESE ARE RENDERINGS ONLY. ACTUAL FLOOR PLANS & ELEVATIONS MAY VARY FROM DRAWINGS.