

D

2106

117-119 PUMPKIN RIDGE COURT

D



STONE AT FRONT AS SHOWN

**FRONT ELEVATION**

CEMENT LAP SIDING

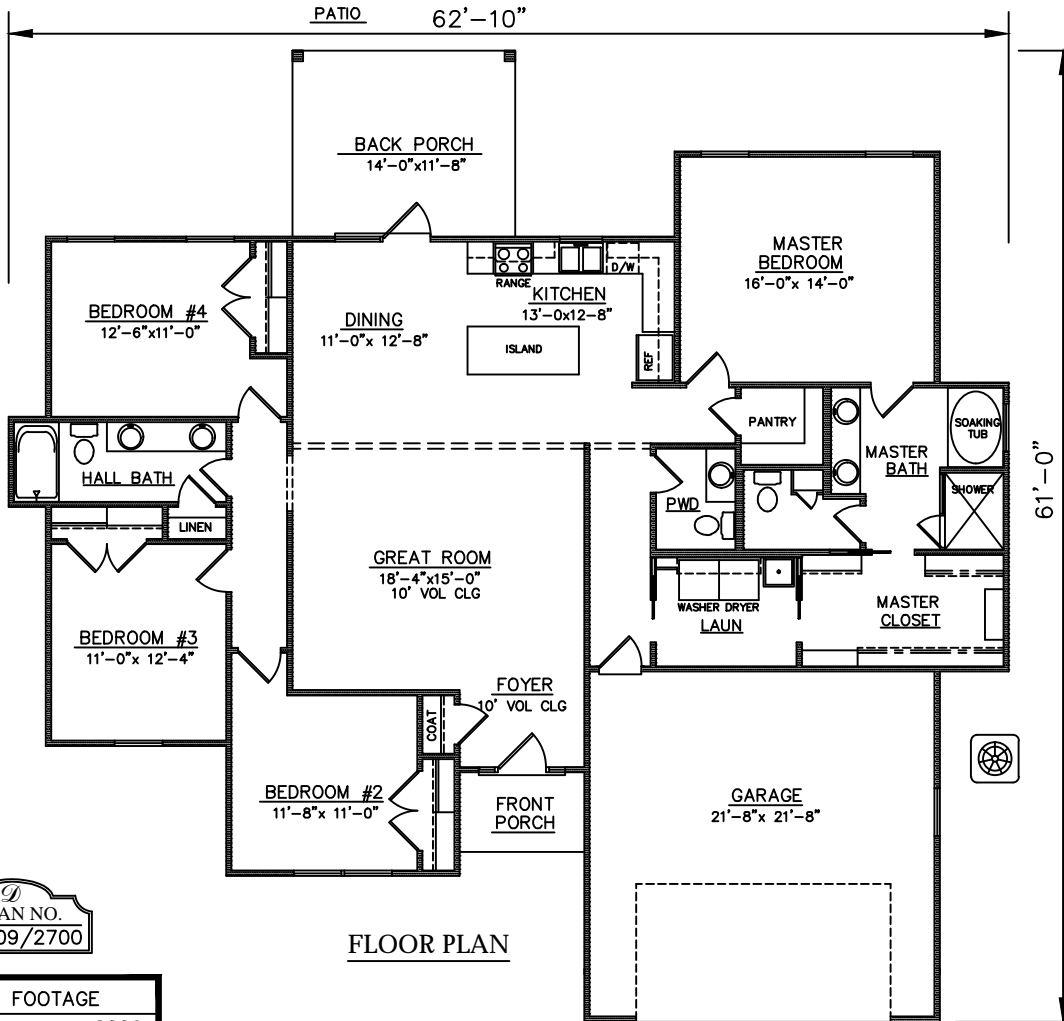

**FLOOR PLAN**

PLAN NO.  
CW2009/2700

SQUARE FOOTAGE	
Heated Sq. Ft.:	2009
Garage:	489
Front Porch:	39
Back Porch:	163
Total Under Roof:	2700

3805 COMMUNITY ROAD  
BRUNSWICK, GEORGIA  
(912)265-3021  
www.driggerhomes.com



SERVING GLYNN COUNTY  
SINCE 1962

THE INFORMATION, PLANS, SPECIFICATIONS, AND DESIGNS APPEARING IN THESE DRAWINGS ARE THE PROPERTY OF DRIGGERS HOMES, INC.; ANY UNAUTHORIZED USE OR DUPLICATION IN WHOLE OR IN PART IS STRICTLY PROHIBITED.

**NEW HOME COLLECTION**

THESE ARE RENDERINGS ONLY. ACTUAL FLOOR PLANS & ELEVATIONS MAY VARY FROM DRAWINGS.